

vital baby®



# NURTURE™

pro steam steriliser & dryer



**IMPORTANT CARE & USE INFORMATION.  
READ THIS INFORMATION BEFORE USE**

**BPA  
FREE**

# IMPORTANT, RETAIN FOR FUTURE REFERENCES: READ CAREFULLY BEFORE USE.

## For your safety and health **WARNING!**

- The appliance is designed for domestic use only and must be used in accordance to these instructions. Please read carefully and retain for future use.
- The appliance should not be used by children under the age of 16 or persons with reduced mental capabilities, or without the required knowledge or experience. The product can be used by persons with reduced physical or sensory capabilities, as long as they are under supervision or after they have received instructions for the safe use of the appliance and have understood the hazards involved. If the appliance is sold by the purchaser or given to third party users, they must receive the instructions for the safe use. It is important to understand the hazards involved, through reading the user manual and the safety warnings contained in it.
- The cleaning and maintenance to be performed by the user should not be carried out by children under the age of 16 and / or people with reduced mental capabilities or missing experience or required knowledge.
- The appliance is intended for indoor use only.
- Keep the appliance out of the reach of children. **THIS IS NOT A TOY.**
- Do not tug on the power cable or the appliance to unplug from the wall.
- For safety reasons the appliance must always be connected to an electricity system which has efficient earthing connections.
- During the sterilising cycles, hot steam is released that could cause burns/injury. All parts in contact with the steam will become very hot. Always pay attention when using and handling this product.
- Check that the power cable is always unplugged from the mains socket and that the appliance is drained of excess water before moving, cleaning, and storing.
- Do not open or try to open the steriliser when the appliance is performing a sterilising/drying cycle.
- Beware of hot steam that comes from the machine during use and when you open the lid following a cycle - **STEAM IS HOT AND CAN BURN.** Do not obstruct the vents when in use.
- To immediately stop the appliance mid cycle, turn off at the mains socket and disconnect the power cable.
- Never use the sterilising function without water.
- Do not attempt to disassemble the appliance - **RISK OF ELECTRIC SHOCK.**
- Regular care and cleaning is essential to maintain the appliance in peak working order.
- Keep the appliance well away from other objects when in use. Do not place items on top of the appliance when in use.
- Wait at least 3 minutes before attempting to remove the lid to allow the steriliser to cool to prevent burns.
- Wash your hands thoroughly before touching sterilised items.
- Remove the lid carefully - there may still be hot water and steam in the steriliser.
- Once bottles and accessories have been removed from the steriliser they must be assembled immediately or re-sterilised.
- Do not rinse after sterilising.
- Allow the steriliser to cool for at least 10 minutes in-between each use to allow the thermostat to cool.
- After each use and when the steriliser has cooled completely, pour away any remaining water and wipe dry.
- The appliance may break if dropped.
- Do not make any adjustments to the original plug.
- Before using the appliance always check that its components are not damaged. If damage is found do **NOT** use the appliance.
- Unwind the cord completely before inserting the plug into the socket; this is to prevent possible overheating of the appliance.

- Do not place the appliance on or near hot surfaces or appliances such as microwaves or ovens.
- The appliance does not contain parts or components serviceable by the user.
- Clean all components thoroughly before first use and after each use.
- Never immerse the appliance in water or any other liquids.
- Place the appliance on flat and stable surfaces only.
- Always use the tongs provided to remove the teats and accessories and re-assemble parts.
- Never cover or block the air intake.
- Do not store or leave in direct sunlight, near a source of heat or near a source of water as this could damage the product.

## CLEANING AND MAINTENANCE

- Before first use and after each use, clean all components thoroughly with hot, soapy water. Wring excess water from the cloth or sponge before wiping the appliance. After cleaning and before using for the first time, run a full 46-minute auto cycle, followed by a 6-minute sterilising cycle. This is to ensure hygiene.
- Do not use bleach, abrasive materials, abrasive solutions or scourers to clean the product. Never pour bleach or sterilising solutions/tablets into the appliance.
- Before each use ensure that all items to be sterilised have been thoroughly cleaned.
- During use over time and depending on the quality of your water, a limescale deposit may build up in the base unit. This can affect the efficiency and general working order of your steriliser, and so it is recommended that regular descaling is carried out.
- After each use and when steriliser has cooled completely, pour away any remaining water and wipe dry.

## REPLACING THE FILTER

The pro steam steriliser and dryer uses a high-efficiency HEPA air filter, intercepting 99.97% of bacteria and airborne particles. We recommend that this filter is changed every 6 months.

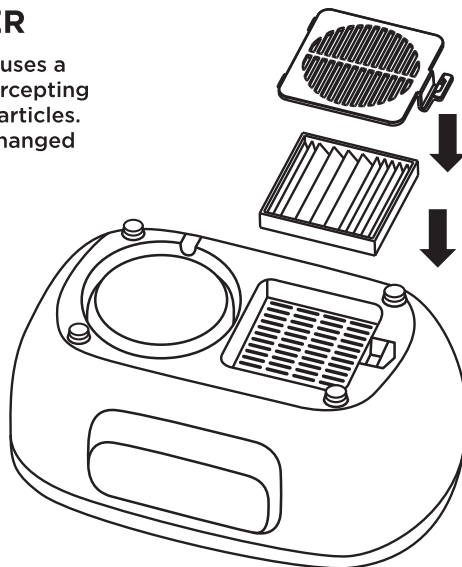



# STERILISING

1. Clean the steriliser and all items going into the steriliser thoroughly before placing in the steriliser.
2. Pour 100ml of clean water on to the heating plate in the base unit.



**NOTE** When pouring water into the steriliser, water should never exceed the marked MAX limit.

3. Place the items for sterilising into the steriliser. If sterilising bottles, they should be fully disassembled and placed upside down in the steriliser for efficiency. For smaller items, you can set the central compartment aside and use only the upper tray and lid. *See diagram 1.*

**NOTE** all items must be disassembled before sterilisation where applicable.

4. Press the  to turn the machine on, and then press the  button to select the sterilising function.
5. The default time of 6 minutes will be displayed on the screen for 2 seconds, after which the sterilising cycle will automatically begin.
6. Allow the steriliser and contents to cool for at least 3 minutes before attempting to lift the lid. Once removed from the steriliser, sterile contents must be assembled immediately. Always handle sterile goods with clean hands.
7. Once the steriliser has completely cooled, pour away any remaining water.

# DRYING

1. Clean the steriliser and all items going into the steriliser thoroughly before placing in the steriliser.
2. Press the  to turn the machine on, and then press the  button to select the drying function.
3. Place the items for drying into the steriliser. If drying bottles, they should be fully disassembled and placed upside down in the steriliser for efficiency. For smaller items, you can set the central compartment aside and use only the upper tray and lid. *See diagram 1.*

4. The default time of 40 minutes will be displayed on the screen for 2 seconds, after which the sterilising cycle will automatically begin.
5. If the dried items in the steriliser had previously been through a sterilising cycle, the sterile contents must be assembled immediately once removed from the steriliser. Always handle sterile goods with clean hands.

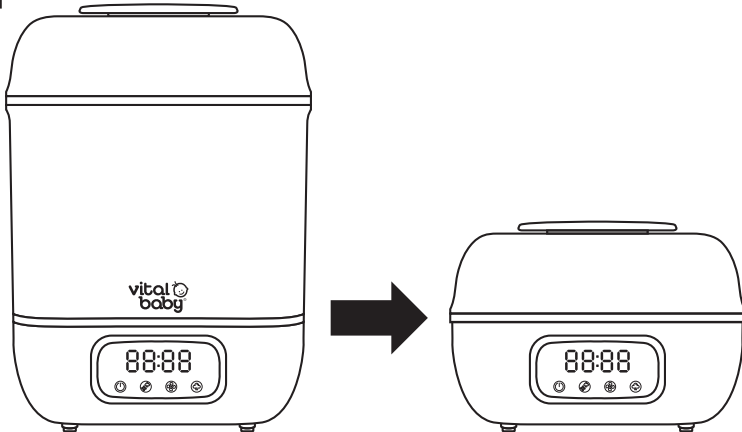

DIAGRAM 1



## AUTO MODE

1. Clean the steriliser and all items going into the steriliser thoroughly before placing in the steriliser.
2. Pour 100ml of clean water on to the heating plate in the base unit.

**NOTE** When pouring water into the steriliser, water should never exceed the marked MAX limit.

3. Place the items for sterilising into the steriliser. If sterilising bottles, they should be fully disassembled and placed upside down in the steriliser. For smaller items, you can set the central compartment aside and use only the upper tray and lid. See *diagram 1*.
4. Press the  to turn the machine on, and then press the \*insert  button to select the auto function.

5. The default time of 46 minutes will be displayed on the screen for 2 seconds, after which the sterilising cycle will automatically begin.
6. After 6 minutes of sterilisation, the steriliser will automatically switch functions to drying mode for the remainder of the cycle.
7. Once removed from the steriliser, the sterile contents must be assembled immediately once removed from the steriliser. Always handle sterile goods with clean hands.
8. Once the steriliser has completely cooled, pour away any remaining water.

### CONTROL PANEL (C)

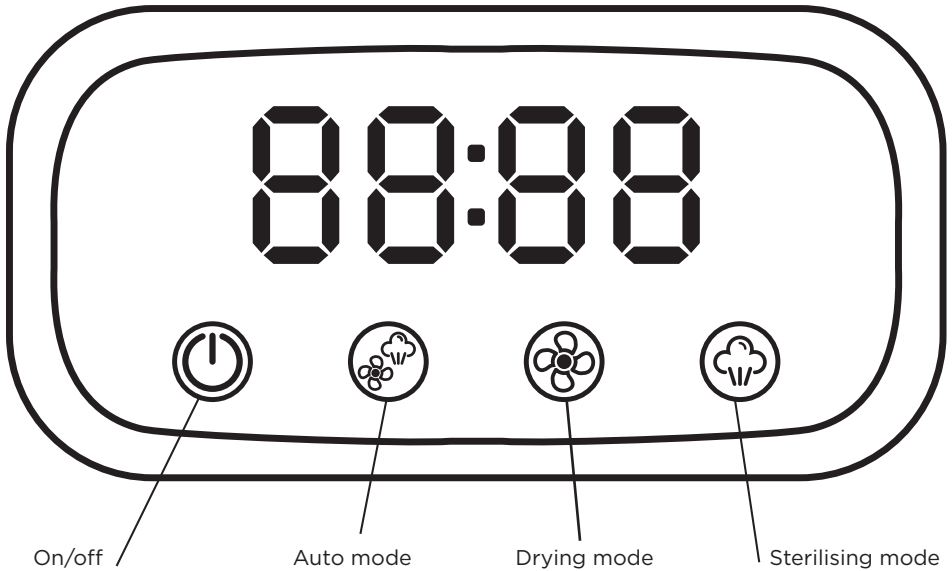

## COMPONENTS

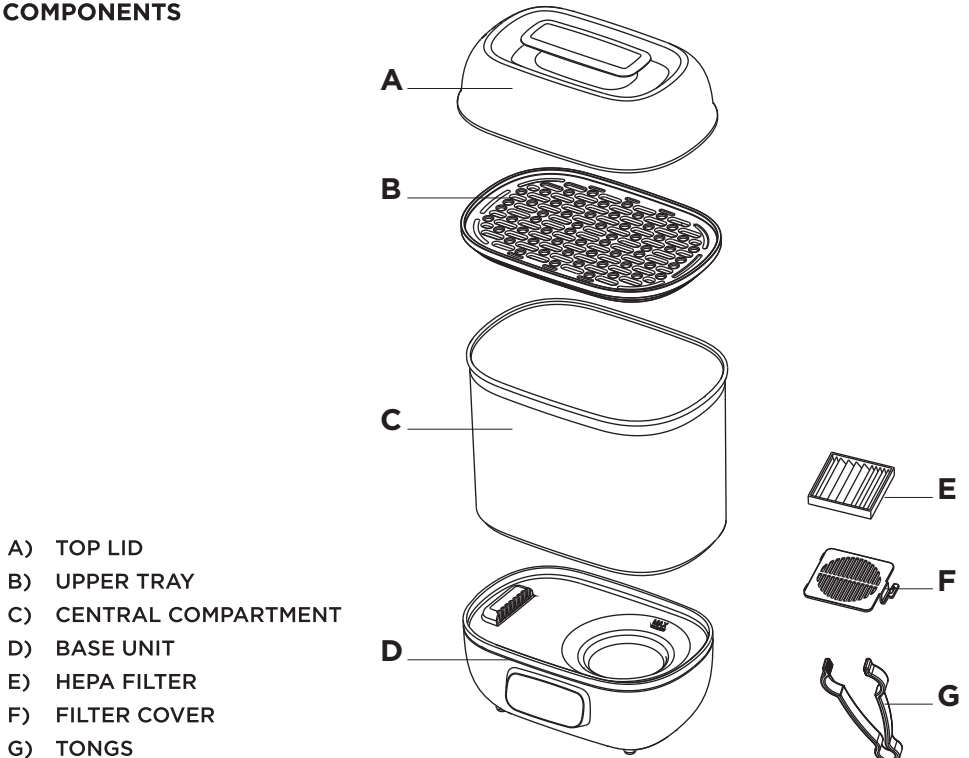

## TECHNICAL SPECIFICATION

Product Name:	Vital Baby® NURTURE™ pro steam steriliser & dryer
SKU:	444281
Model:	TB1713S
Sterilising power:	800W
Dryer power:	150W
Voltage:	220-240V
Weight:	1.95kg



In order to minimise hazards to health and the environment and ensure that materials can be recycled, this product should be disposed of at a separate collection facility for waste electrical and electronic equipment.

[www.vitalbaby.com](http://www.vitalbaby.com)

Made in China to Vital Baby® specifications. Vital Innovations Limited, Hatfield, Herts, AL10 9EW, United Kingdom. Vital Baby® is a registered trademark. NURTURE™ is a trademark. Design Rights. © Vital Innovations Ltd 2020